

# Sunapee School District Community Forum March 5, 2020



Preparing Life Long-Learners and Contributing  
Members of Society





# Total Enrollment

	<b>2017-2018</b>	<b>2018-2019</b>	<b>2019-2020</b>
<b>SCES</b>	163	158	181
<b>SMHS</b>	247	251	251
<b>TOTAL</b>	<b>405</b>	<b>409</b>	<b>432</b>



# New England School Development Council Sunapee Enrollment Projection



K-12 To 2029 Based On Data Through School Year 2019-20

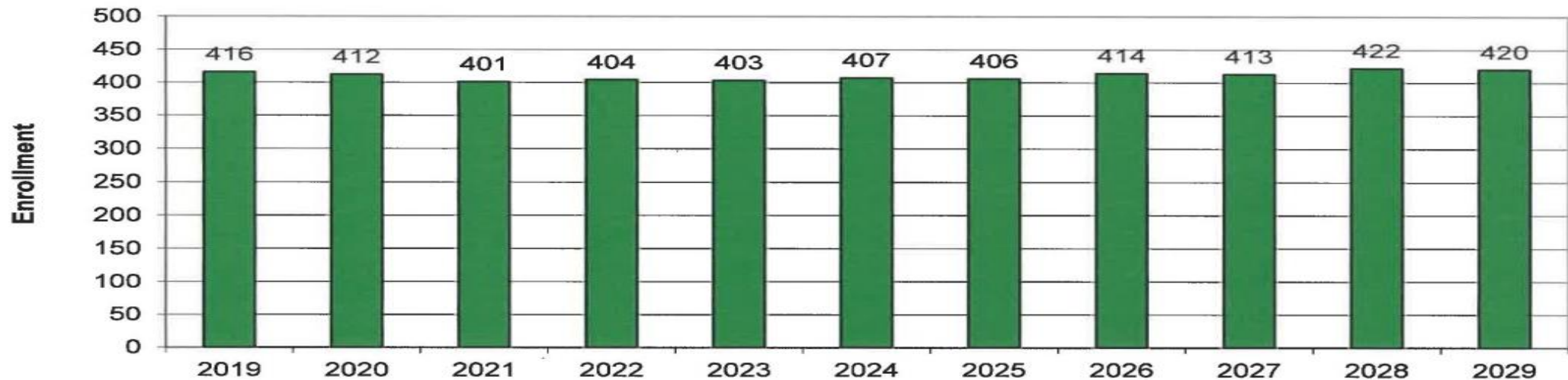

©New England School Development Council • 508-481-9444 • [www.nesdec.org](http://www.nesdec.org)

SUNAPEE  
SCHOOL DISTRICT



# NESDEC Process for Enrollment Study

New England School Development Council

In preparing the demographic component of Sunapee District study, NESDEC reviewed:

- Population and housing data provided by the U.S. Census Bureau
- Birth data provided by the New Hampshire Department of Public Health
- Existing home sales statistics and other related information made available by local realtors
- A regional and New Hampshire analysis produced by the New England Economic Partnership
- Information on Sunapee residential housing provided by the Sunapee Zoning/Planning Department and local realtors
- Analyzed District enrollment data supplied by the District and the New Hampshire Department of Education
- Numbers of Nonresident students or tuition students



# TAX IMPACT on 15 Year Term @ 3.50% Interest Rate

- 2020/2021 - \$0.36/\$1,000 assessed value
- 2021/2022 - \$2.07/\$1,000 assessed value
- Year 10 - \$1.68/\$1,000 assessed value
- Year 15 - \$1.39/\$1,000 assessed value

June 2019 the NH Municipal Bond Bank 15 year interest rate was 2.13%.

January 2020 the NH Municipal Bond Bank 15 year interest rate was 1.83%

February 2020 the NH Municipal Bond Bank 30 year interest rate was 1.627%





**Campus Parking Summary**

On-Campus Parking	159 Spaces
Remote Student Parking	35 Spaces
<b>Total Parking</b>	<b>194 Spaces</b>

**Pickup/Drop-off**

- 7 Busses
- 20 Elementary School Parents
- 25 Middle School Parents

Proposed Elementary School

Sunapee Middle High School  
Sunapee, New Hampshire

November 25, 2019



**Tighe & Bond**  
Engineers | Environmental Specialists



One Story Elementary School Addition





**Department Legend**

- CORE
- EDUCATIONAL SUPPORT
- FACILITIES SUPPORT
- GENERAL CLASSROOMS
- SPECIAL SERVICES
- SPECIALIZED CLASSROOM

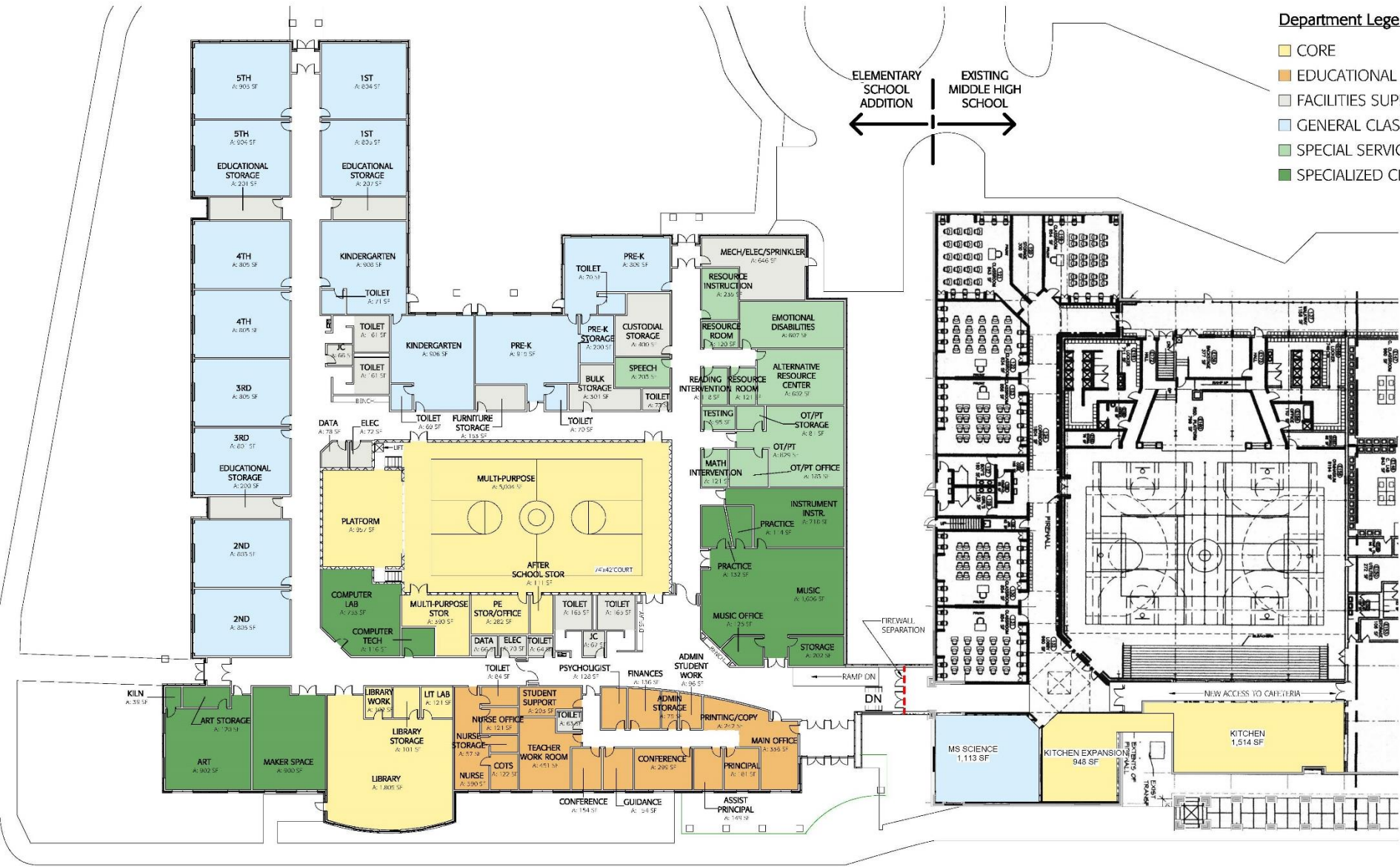



ELEMENTARY SCHOOL ADDITION      EXISTING MIDDLE HIGH SCHOOL

Department Legend

- CORE
- EDUCATIONAL SUPPORT
- FACILITIES SUPPORT
- GENERAL CLASSROOMS
- SPECIAL SERVICES
- SPECIALIZED CLASSROOM

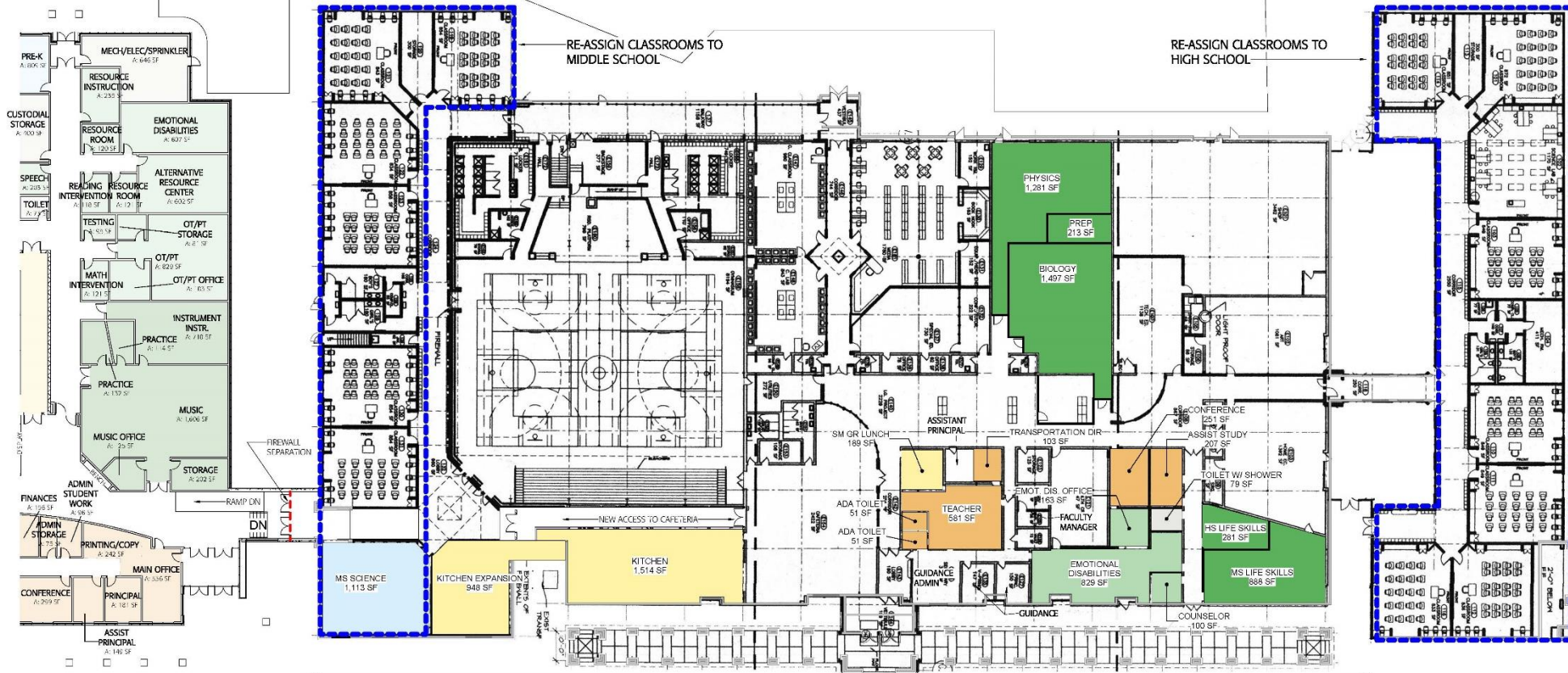

Middle High School Renovation



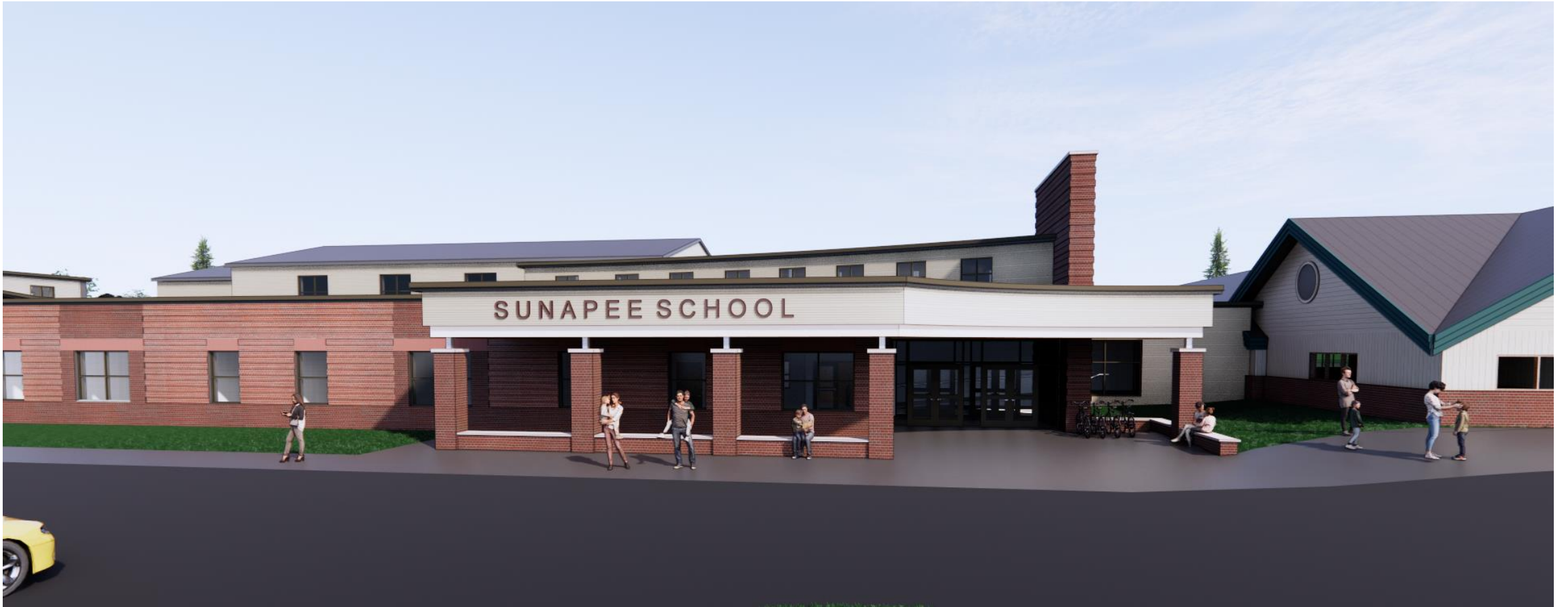

One Story Elementary School Addition







One Story Elementary School Addition







One Story Elementary School Addition





One Story Elementary School Addition







Typical Elementary Music Room

Typical Art Room

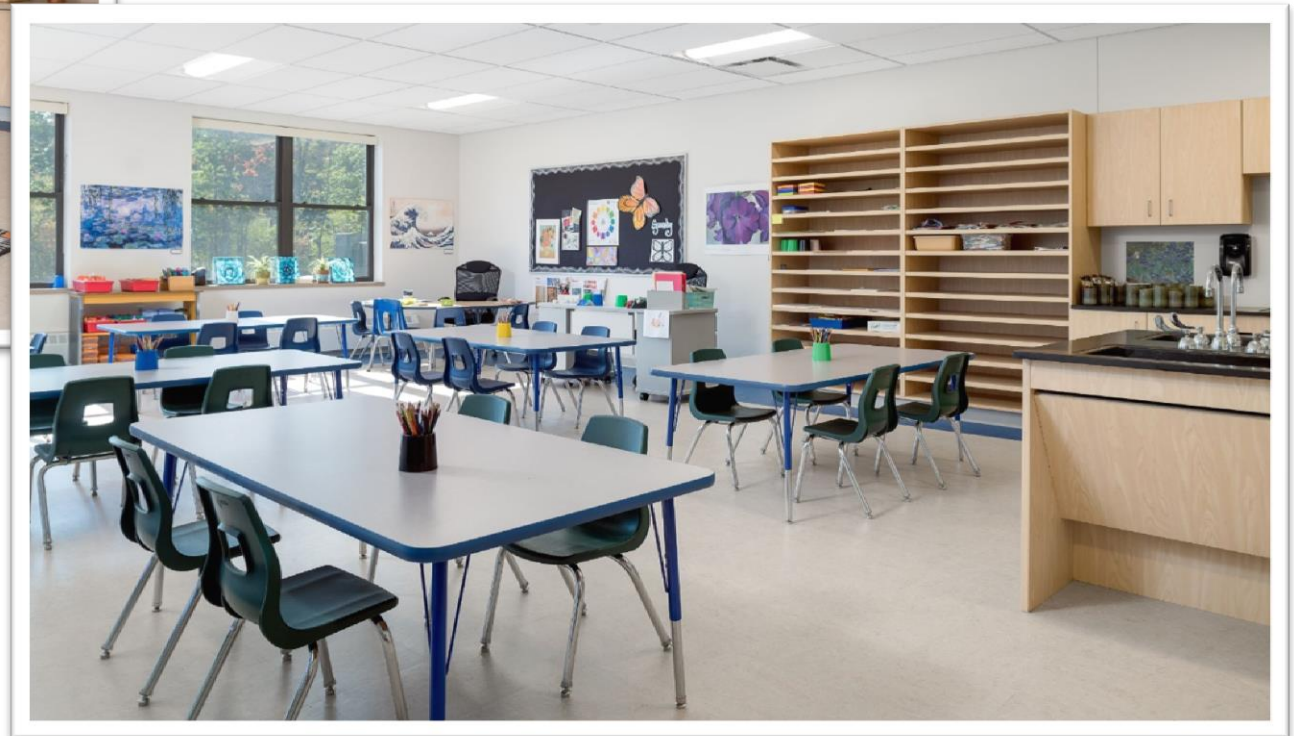

One Story Elementary School Addition





Typical Elementary Classroom



Preschool Room

## Project Benefits

### Highlights

Addresses educational and building fix needs of both schools.

Fixes existing baseball field and provides needed new fields and track



# Elementary School Addition

## Highlights

- **One campus**
  - Simplifies bus routes since one site for both schools
  - Increased time with students
  - Education and cost synergies.
- **Safer**
  - Separate parent drop off
  - Playgrounds away from traffic
  - Safe, secure and central entry for both schools
- **Educational needs met:**
  - Classrooms proper quantity and size
  - Arts/ Maker space (STEAM) wing
  - Special Education provided





# Middle High School Renovation

## Highlights

- **Corrects Building Issues**
  - Acoustic issues
  - Old boiler replaced
  - Gym ventilation
  - Electrical grounding
  - Sunlight to science room
  - Updates Family Consumer Science Kitchens
- **Safer**
  - Separate Student Parking
- **Educational Needs Met:**
  - Fixes Science rooms and
  - “Right Sizes” OT/PT, Music and Life Skills
  - Brings Emotional Disabilities back into district





Remote Fields Key Plan  
7 Hearth Lane



# Fields

## Highlights

- **Fields Are In Town**
  - Remote fields are consolidated and close by
  - Increases home games
  - Reduces costs: renting fields and transportation
- **Satisfies Field Needs**
  - Replace Soccer Field
  - New Cinder Track
  - Replace Softball Field
  - Fixing the existing Baseball Field drainage and irrigation





### Article 3:

Shall the District raise and appropriate the sum of \$25,600,000 (gross budget) for the Sunapee Consolidation School Project, which includes constructing and equipping a new elementary school connected to the Middle High School, constructing and equipping renovations to the Middle High School, renovating existing athletic fields, construction of new athletic fields and a cinder track, and acquiring approximately 6.5 acres of land (part of Tax Map 123, Lot 4)-(the “Project”); and authorize the issuance of \$25,600,000 of bonds or notes in accordance with the provisions of the Municipal Finance Act (RSA Chapter 33); and authorize the School Board to issue and negotiate such bonds or notes and determine the date, maturities, interest rate, and other details of such bonds or notes; and raise and appropriate an additional sum of \$450,489 from taxation for debt service payments due on such bonds or notes during the 2020-2021 fiscal year; and authorize the School Board to accept on behalf of the District any federal, state, or private funds that may become available with respect to the Project?  
*(The Sunapee School Board recommends approval) (3/5 ballot vote required)*

Tax Impact 2020/2021 - \$0.36

2021/2022 - \$2.07



# Costs

## One Story Elementary School Addition

for December 11, 2019 Town Forum | CIP Meeting

New 51,020 sf Elementary School - Single Story Option	\$17,545,273
Middle High School Renovations & Infill	\$3,655,460
New Playing Fields	\$4,378,464
<b>TOTAL:</b>	<b>\$25,579,197</b>



# Costs

## Renovations Only

Renovations to Existing Elementary School	\$10,757,052
Renovations to Existing Middle High School	\$2,207,494
New Playing Fields (Fix Upper Field, Repair Alexander & New Softball at Hearth Lane)	\$4,038,522
<b>TOTAL:</b>	<b>\$17,003,068</b>



## What is Next:

- March 10<sup>th</sup> Bond Vote



Thank you!!

