

# Sunapee School District CIP: Community Forum Meeting

December 11, 2019



**Preparing Life Long-Learners and  
Contributing Members of Society**



# Welcome

## Goals Tonight

Inform

Understand Cost and Tax Impact

Listen



## Process

Where have we been.....

- CIP Committee formed
- Owner Representative and Architect Selected – May & June
- Staff Meetings Input- June
- Community Forum Input- June
- Educational Specifications Established – August
- Community Forum Preliminary Options Reviewed – September
- Exploratory Fields Committee – August thru December (Ongoing)
- Community Forum Options refined and estimated – October
- Options and estimate refined – November- December





# Project Necessity

- Educational Needs
- Fiscally Responsible
- Outdated and Vintage Facilities
- Safety
- Accessibility



| NAME                           | SCHOOL /ORCAF | STATE STANDARD     | EXISTING ROOM # | EXIST. AREA | EXIST. NEEDS | NEW NEEDS | RECOMMEND ACTIONS | PRINTS | COMMENTS   |
|--------------------------------|---------------|--------------------|-----------------|-------------|--------------|-----------|-------------------|--------|--|
| General Classroom              |               | State Curriculum   |                 |             |              |           |                   |        | 900 SF & 10' x 10' pupil for MC, 800 SF min. & 32' x 40' pupil for 15' utility rated |
| C. ASSESS004                   | HS            |                    | -13             | 8,00        | 8,00         |           |                   |        | 7th Algebra, Algebra, pre calc, calc   |
| E. ASSESS004                   | HS            |                    | -2              | 2,92        | 2,92         |           |                   |        | Geometry, Algebra, Stats, Advanced Math  |
| F. ASSESS004                   | HS            |                    | -4              | 1,54        | 1,54         |           |                   |        | Foreign Language   |
| G. ASSESS004                   | HS            |                    | -14             | 1,54        | 1,54         |           |                   |        | Foreign Language   |
| H. ASSESS004                   | HS            |                    | -15             | 8,83        | 8,83         |           |                   |        | U.S. History, Global Studies, 1. Elective  |
| I. ASSESS004                   | HS            |                    | -16             | 8,83        | 8,83         |           |                   |        | Grade 8 History, Economics   |
| J. ASSESS004                   | HS            |                    | -17             | 8,83        | 8,83         |           |                   |        | Sections of High School English  |
| K. ASSESS004                   | HS            |                    | -18             | 66,9        | 66,9         |           |                   |        | Grade 8 Science, Grade 8 Math, Grade 8 Math  |
| L. ASSESS004                   | MS            |                    | -18             | 66,9        | 66,9         |           |                   |        | Grade 5 science, grade 7, science, elective  |
| M. ASSESS004                   | MS            |                    | -18             | 66,9        | 66,9         |           |                   |        | Grade 7 math, 7th math support, yearbook   |
| N. ASSESS004                   | MS            |                    | -17             | 67,2        | 67,2         |           |                   |        | Grade 6 English, 6th grade off-site library  |
| O. ASSESS004                   | MS            |                    | -18             | 67,1        | 67,1         |           |                   |        | Grade 6, 8 and 9 English   |
| P. ASSESS004                   | MS            |                    | -18             | 66,9        | 66,9         |           |                   |        | 6th grade science, English   |
| General Classroom Subtotal     |               |                    |                 | 11,965      | 11,965       | 0         | 0                 | 0      |  |
| Specialized Classroom          |               |                    |                 |             |              |           |                   |        |  |
| ART CLASSROOM                  | MS/HS         | 11000 & 60 d/pupil | C11             | 1,061       | 1,061        |           |                   |        | MS, HS, Art  |
| ART MEDIA ROOM                 | MS/HS         |                    | C12             | 36          | 36           |           |                   |        |  |
| ART STORAGE                    | MS/HS         |                    | C11             | 1,025       | 1,025        |           |                   |        |  |
| COMPUTER CLASSROOM             | MS/HS         | 11000 & 60 d/pupil | C5              | 647         | 647          |           |                   |        | Art room   |
| COMPUTER STORAGE               | MS/HS         | 11000 & 60 d/pupil | C18             | 1,976       | 1,976        |           |                   |        | Art Storage and I.T. Media   |
| COMPUTER STORAGE               | MS/HS         |                    | C10             | 35          | 35           |           |                   |        | Computer, Work, CONFERENCE ROOMS, VIDEO, etc.  |
| MUSIC GENERAL CLASS ROOM       | MS/HS         | 11000 & 60 d/pupil | C8              | 1,555       | 1,555        |           |                   |        | Music theory & electives - lessons   |
| MUSIC REHEARSAL                | MS/HS         |                    | C9              | 1,108       | 1,108        |           |                   |        |  |
| MUSIC REHEARSAL                | MS/HS         |                    | C15             | 1,34        | 1,34         |           |                   |        |  |
| MUSIC REHEARSAL                | MS/HS         |                    | C20             | 77          | 77           |           |                   |        |  |
| MUSIC REHEARSAL                | MS/HS         |                    | C21             | 77          | 77           |           |                   |        |  |
| MUSIC REHEARSAL                | MS/HS         |                    | C22             | 1,108       | 1,108        |           |                   |        |  |
| SCIENCE CLASSROOM              | HS            | 11000 & 60 d/pupil | C13             | 1,212       | 1,200        |           |                   |        | 20 students, Biology, Anatomy, Environmental, Marine                                 |
| SCIENCE CLASSROOM              | HS            | 11000 & 60 d/pupil | C7              | 1,100       | 1,000        |           |                   |        | 20 students, Physical, Chemistry, Physics  |
| SCIENCE CLASSROOM              | MS            | 11000 & 60 d/pupil | C14             | 1,110       | 1,100        |           |                   |        | Grade 7 & 8 Science  |
| SCIENCE REHEARSAL              | MS            |                    | C16             | 36          | 36           |           |                   |        | Science Lab  |
| SCIENCE CLASSROOM              | MS/HS         | 11000 & 60 d/pupil | C17             | 619         | 619          |           |                   |        |  |
| SCIENCE CLASSROOM              | MS/HS         |                    | C19             | 5,402       | 5,402        |           |                   |        | General teaching   |
| SCIENCE CLASSROOM              | MS/HS         |                    | C23             | 900         | 900          |           |                   |        |  |
| Specialized Classroom Subtotal |               |                    |                 | 14,140      | 14,207       | 0         | 0                 | 0      |  |

| REVISION NUMBER | DATE | COMMENTS  |
|-----------------|------|---|
| 1               |      | Final Review of all drawings and specifications. All items are to be checked for accuracy and completeness. All items are to be checked for accuracy and completeness. All items are to be checked for accuracy and completeness. |
| 2               |      | Final Review of all drawings and specifications. All items are to be checked for accuracy and completeness. All items are to be checked for accuracy and completeness. All items are to be checked for accuracy and completeness. |
| 3               |      | Final Review of all drawings and specifications. All items are to be checked for accuracy and completeness. All items are to be checked for accuracy and completeness. All items are to be checked for accuracy and completeness. |
| 4               |      | Final Review of all drawings and specifications. All items are to be checked for accuracy and completeness. All items are to be checked for accuracy and completeness. All items are to be checked for accuracy and completeness. |
| 5               |      | Final Review of all drawings and specifications. All items are to be checked for accuracy and completeness. All items are to be checked for accuracy and completeness. All items are to be checked for accuracy and completeness. |





**Campus Parking Summary**

|                        |                   |
|------------------------|-------------------|
| On-Campus Parking      | 159 Spaces        |
| Remote Student Parking | 35 Spaces         |
| <b>Total Parking</b>   | <b>194 Spaces</b> |

**Pickup/Drop-off**

- 7 Busses
- 20 Elementary School Parents
- 25 Middle School Parents

Proposed Elementary School

Sunapee Middle High School  
Sunapee, New Hampshire

November 25, 2019



**Tighe & Bond**  
Engineers | Environmental Specialists



**One Story Elementary School Addition**







**One Story Elementary School Addition**





**One Story Elementary School Addition**







**One Story Elementary School Addition**





**One Story Elementary School Addition**





**One Story Elementary School Addition**





**One Story Elementary School Addition**



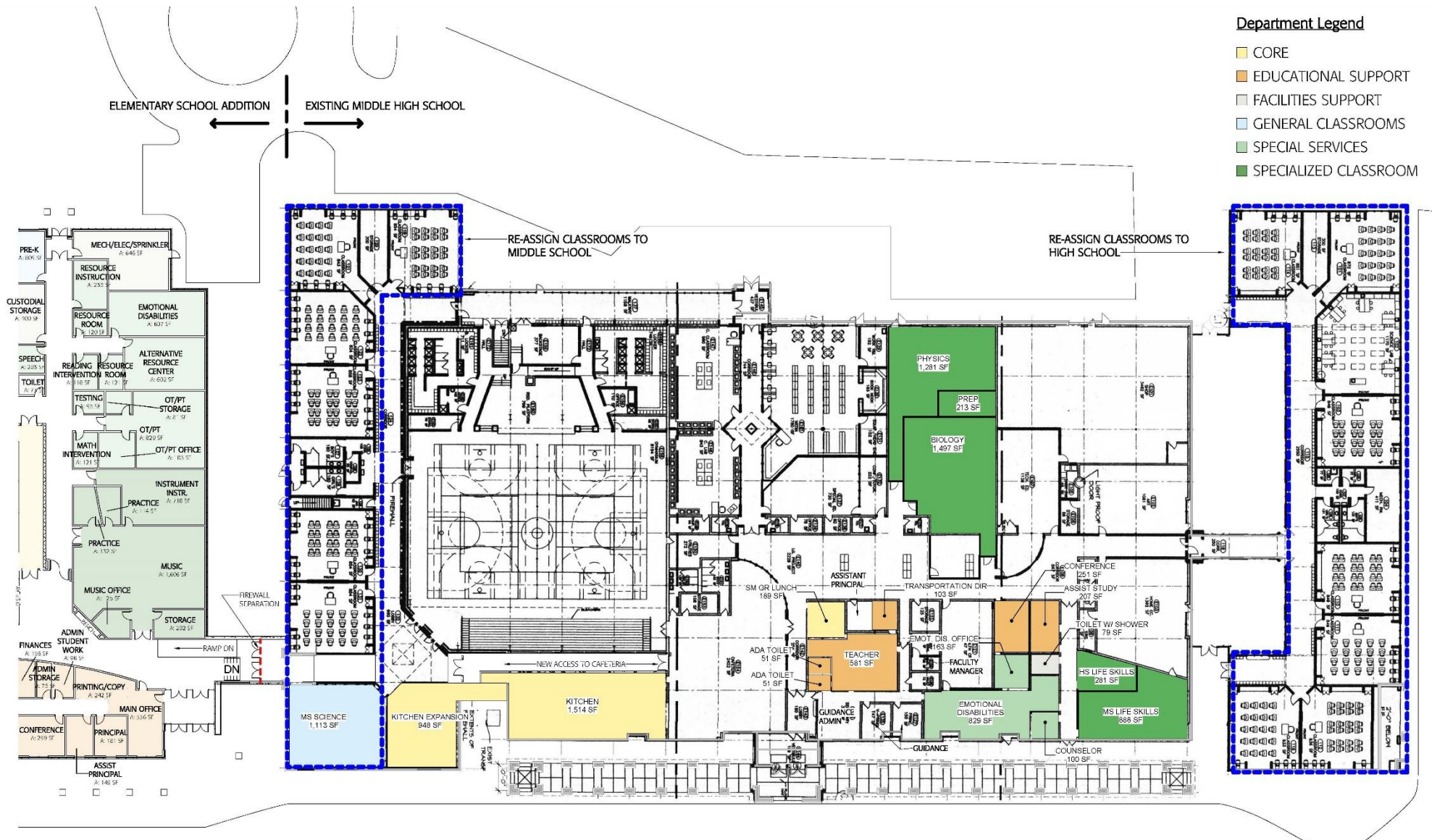

## Middle High School Renovation



# One Story Elementary School Addition

## Highlights

- One centralized campus for all schools
- Simplifies bus routes since one site for both schools
- Increased time with students
- Flat site
- All one story so do not need stairs or elevator
- Separate parent drop off from bus drop off
- Pre-k through first grade playgrounds are accessible from classrooms do not have to cross traffic
- Building on land the school currently owns
- Possible single phase with minimum school disruption during construction
- Interior connection between the Elementary and Middle High School.
- Education and cost synergies.
- Less additions/ cost to MHS for Life skills, OT/PT, Assisted Study
- Safe, secure and central entry for both schools
- Centralized administration for both schools
- One Cafeteria/ food service for both schools
- Improved Music facility with support for MHS students
- Public areas at center
- All spaces are sized per program
- Arts/ Maker space (STEAM) wing
- Kindergarten and Pre-School have direct exterior doors



# Middle High School Renovation

## Highlights

- Educational/instruction program needs met
- Minimal additions/cost
- Middle school closest to Elementary School
- Life Skills adjacent to Home Economics
- Designated and separated student parking area





**Remote Fields Key Plan**  
**7 Hearth Lane**







7 Hearth Lane  
 Site Concept  
 Sunapee Middle  
 High School  
 Sunapee, New Hampshire  
 October 24, 2019

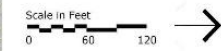

**Tighe&Bond**  
 Engineers | Environmental Specialists



**Softball Field**  
**7 Hearth Lane**





Old Route 11  
Site Concept

Sunapee Middle  
High School  
Sunapee, New Hampshire

November 27, 2019

Scale in Feet  
0 50 100 →

**Tighe & Bond**  
Engineers | Environmental Specialists



## Soccer and Track 7 Hearth Lane



# Fields

## Highlights

- New Soccer Field
- New Track
- New Softball Field
- Fixing the existing Baseball Field drainage and irrigation
- New sod at the upper Baseball Field
- All Fields are in town
- Remote fields are consolidated and close by
- Increases home games
- Reduces cost of renting fields and transportation to them
- Remote fields reduces project cost



# Costs

## One Story Elementary School Addition

for December 11, 2019 Town Forum | CIP Meeting

|   |                     |
|---|---------------------|
| New 51,020 sf Elementary School - Single Story Option | \$17,545,273        |
| Middle High School Renovations & Infill               | \$3,655,460         |
| New Playing Fields                                    | \$4,378,464         |
| <b>TOTAL:</b>   | <b>\$25,579,197</b> |



# Bond Tax Impact

LEVEL PRINCIPAL 25 Million \$ Bond

The Principal Payments are equal every year

Usually results in the lowest interest rate

Generally results in a higher impact on the tax rate in the early years

| Term<br>Years | Bond Amount | Level Principal<br>Payment Plan |               | Tax Effect | Tax Effect<br>on a<br>\$100,000<br>Assessment |
|---------------|-------------|---------------------------------|---------------|------------|---|
|               |             | Debt Payment                    | Tax<br>Effect | Level P.   |   |
| 15            | 25,000,000  | 2,515,775                       | 2.05          |            | \$205   |
| 20            | 25,000,000  | 2,164,063                       | 1.76          |            | \$176   |
| 25            | 25,000,000  | 1,980,000                       | 1.61          |            | \$161   |

\*\*\*\*To calculate your own tax impact multiply the estimated tax effect by your home assessment\*\*\*\*



# Bond Tax Impact

| Term Years | Interest Rate |
|------------|---------------|
| 10         | 3.25          |
| 15         | 3.50          |
| 20         | 3.75          |
| 25         | 4.00          |



## What is Next:

- December 18<sup>th</sup>
  - CIP meeting
  - School Board Meeting: CIP presents project (informational session)
- January 15<sup>th</sup>: Budget Hearing and School Board Meeting
- February 3<sup>rd</sup>: Deliberative Session
- March 10<sup>th</sup> Bond Vote



# Thank you!!

